

## Table of Contents

PREFACE .....	2
iOS – Microsoft Remote Desktop .....	2
Quick Setup - Cloud Setup for iOS Devices – Apple iPad (For advanced users): .....	3
Detailed instructions - Cloud Setup for iOS Devices – Apple iPad/ Apple iPhone .....	3

# ADVANTAGE CLOUD™ Cloud 4

## Installation instructions for iOS (Apple iPhone/iPad)

### PREFACE

In order to access Compulink’s Advantage Cloud services, a Remote Desktop application with Gateway settings is required. Compulink requires the use of **Windows App Mobile** (previously called Microsoft Remote Desktop) App for iOS mobile devices.

### Windows App Mobile

#### Download and install Windows App Mobile rom the Apple’s App Store

- If you already have this app installed, skip this section
- Visit Apple’s App Store and locate the **Windows App Mobile**
- Download and install the application

Quick and detailed setup instructions are provided below.



### Quick Setup - Cloud Setup for mobile Devices – (For advanced users):

If you are familiar with advanced Remote Gateway access, configure the application with the settings below. For step by step instructions, go to [Detailed Instructions](#).

#### Configuration Settings:

1. Select **+** to add new entry and Select **Workspace**
2. **Add** URL/Email: [go@e1d.compulink.net](mailto:go@e1d.compulink.net) and select **Done**
3. Select **User Account** -> **Add User Account** and add Cloud credentials assigned to you (e.g. **CLC\YourAssignedUsername**)
4. Add Cloud Password: Your assigned password (starts with your account number) and select **Save**
5. Select **Find Feed** and **Subscribe**
6. Under **Work Resources**, select **Advantage**
7. Click Menu at the top of the screen -> select Mouse Pointer -> select Start Menu -> launch Advantage Software
8. Click Start -> Advantage to launch your Advantage application
9. When Finished, close your Advantage product and select Log Off

### Detailed instructions - Cloud Setup for iOS and Android devices

1. Select **+** to add new entry and Select **Workspace**

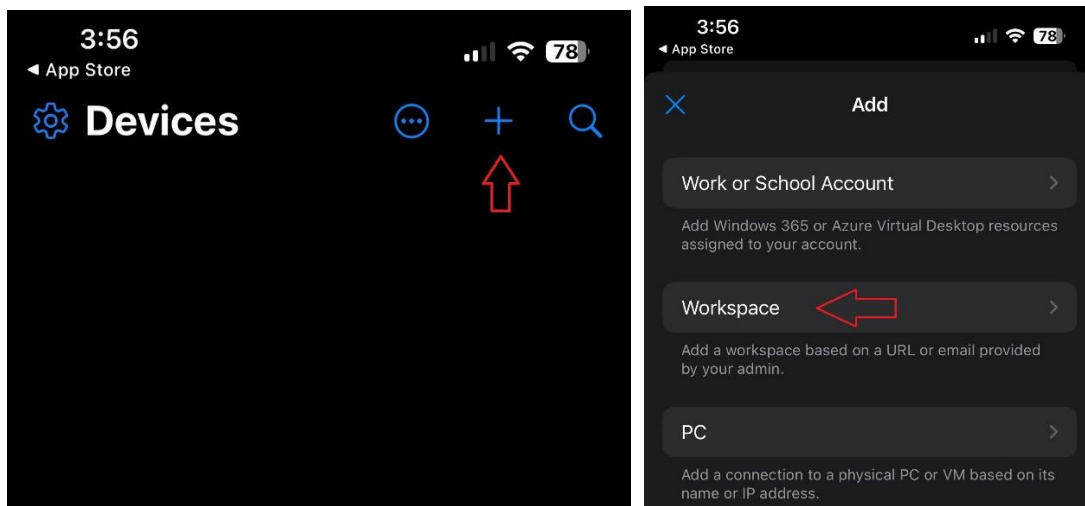

2. Add URL/Email: [go@e1d.compulink.net](mailto:go@e1d.compulink.net) select **Next**

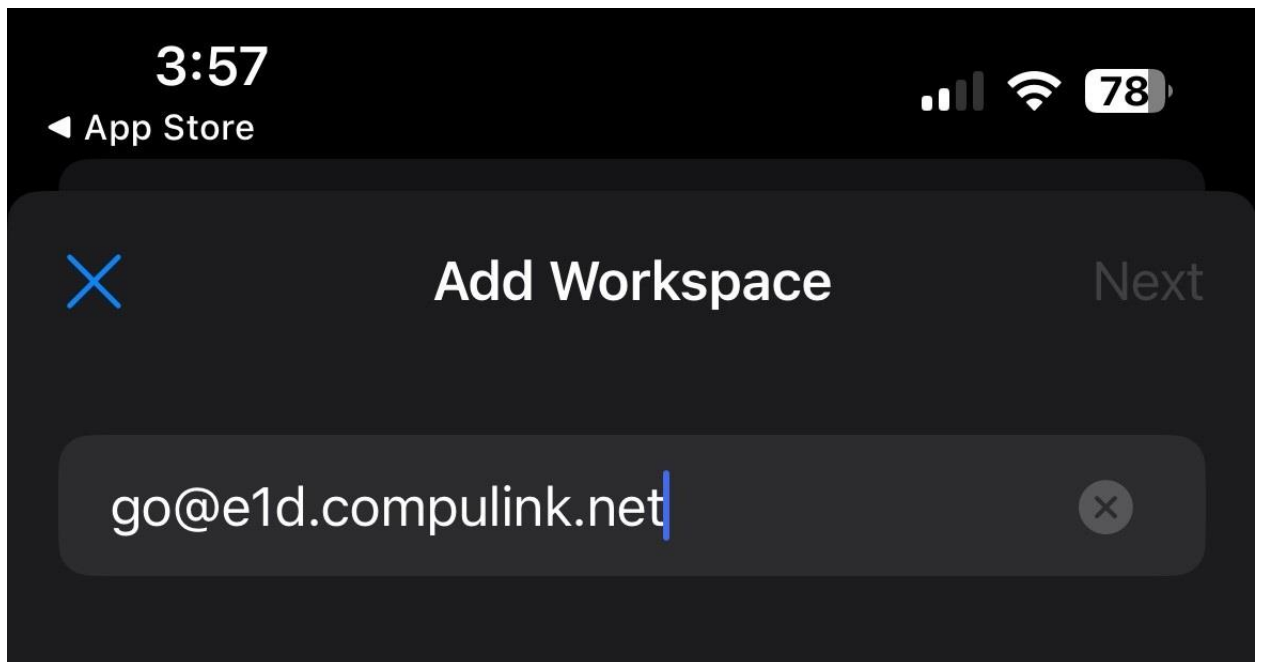

3. Enter in your Advantage Cloud **username** and **password** and select **Continue**

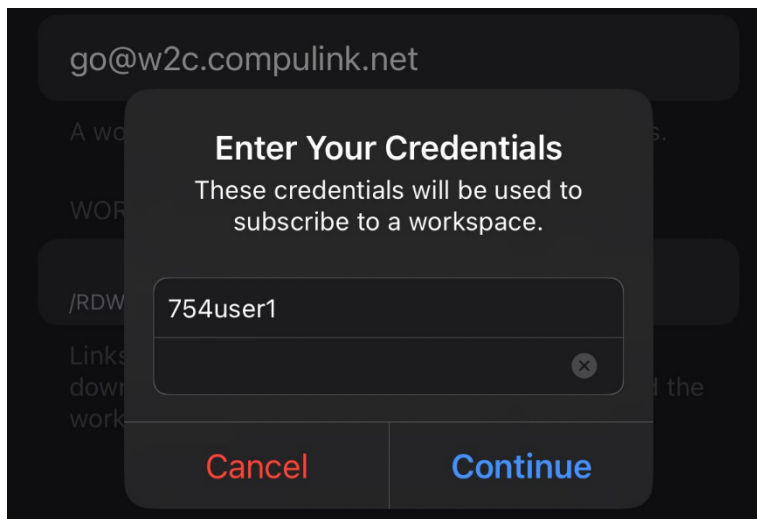

4. Under **Work Resources**, select **Advantage**



5. Enter in your Cloud **username** and **password** that you would like to use to sign in, click **Continue**

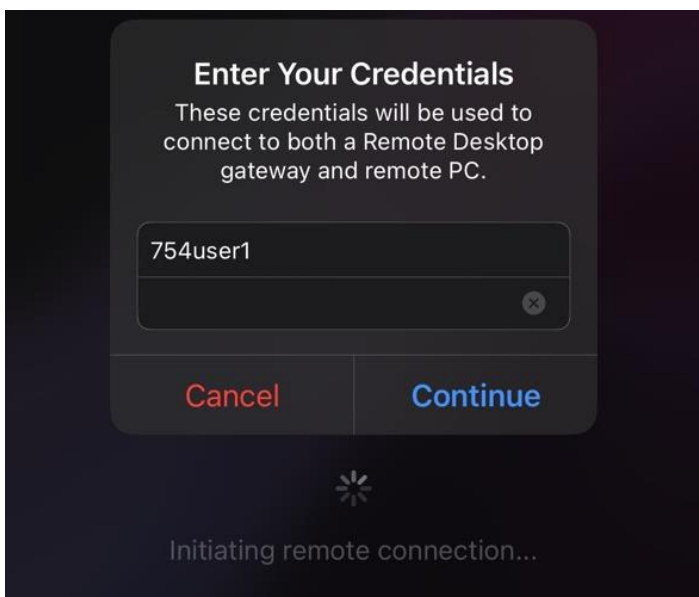

6. You are now signed into the Advantage Cloud, just like if you were in front of a desktop or laptop
  - a. Select the **Menu** button at the top **(1)** to change how your mouse control works
  - b. Select the **Start** button **(2)** in the bottom-left to launch the Advantage software

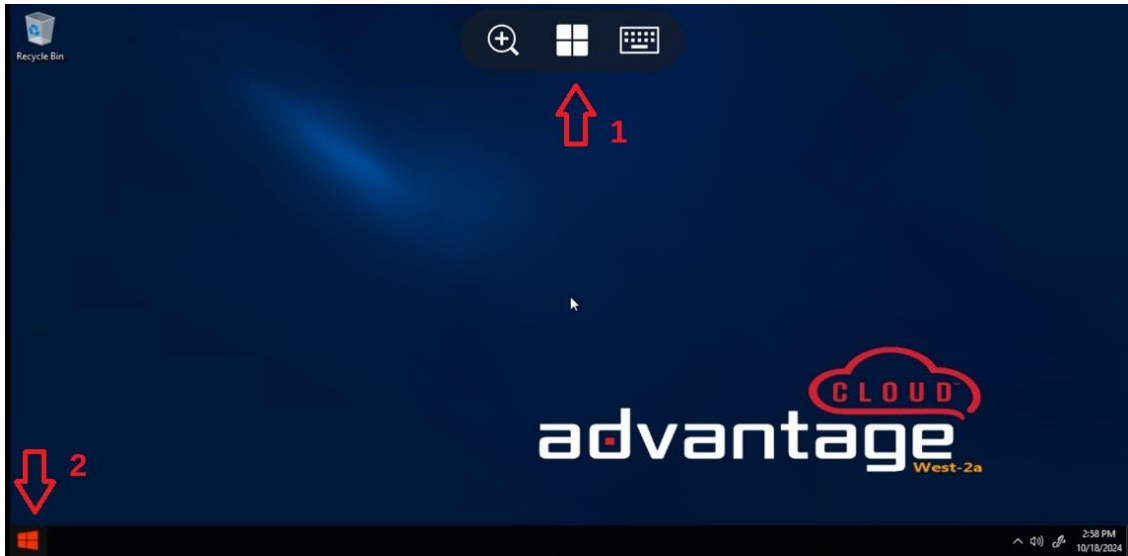

7. Once you select **(1)** from the previous image, you will see this screen below. Select **(1)** for touch-screen mode. If you select **(2)** then it will give you a traditional mouse mode where you drag your finger on the screen to move the mouse cursor. Press **(3)** after your selection.

